

Midland County Clerk Unofficial Copy

Midland County Clerk Unofficial Copy

Midland County Clerk

STATE OF TEXAS §
COUNTY OF Ector §

This instrument was acknowledged before me on the _____ day of _____, 1992, by Premaltha Vindhya

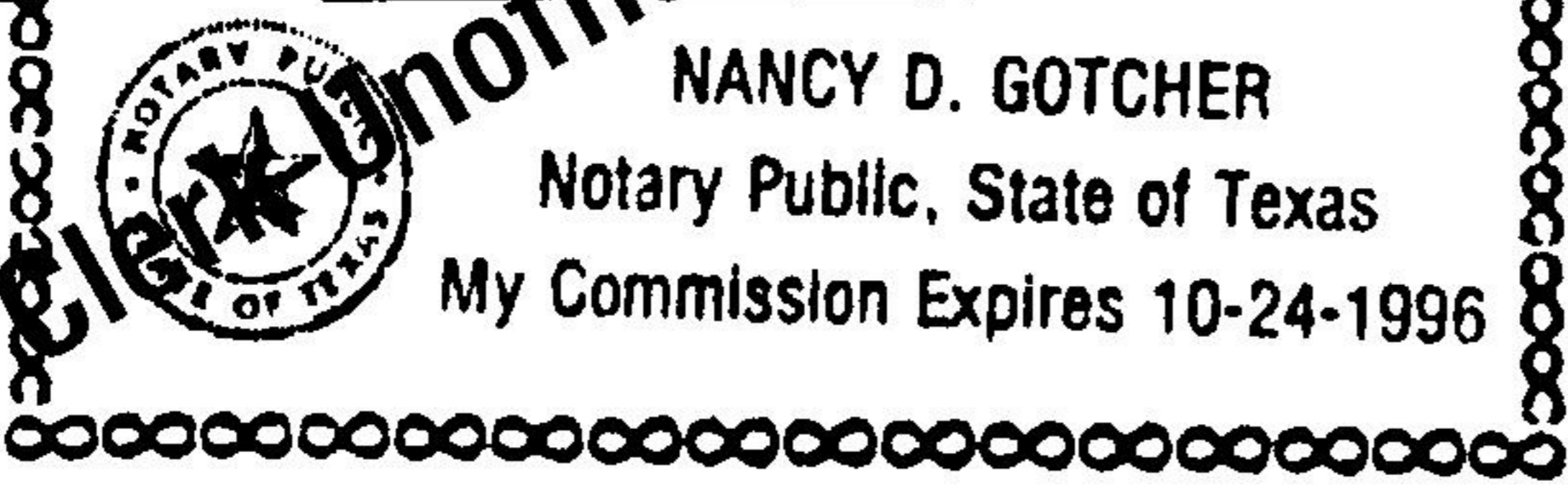

Nancy D. Gotcher
Notary Public, State of Texas

Midland County Clerk Unofficial Copy

Midland County Clerk Unofficial Copy

Midland County Clerk

STATE OF TEXAS §
COUNTY OF Midland §

This instrument was acknowledged before me on the 28th day of October, 1992, by Roy Proctor, in the capacity therein stated.

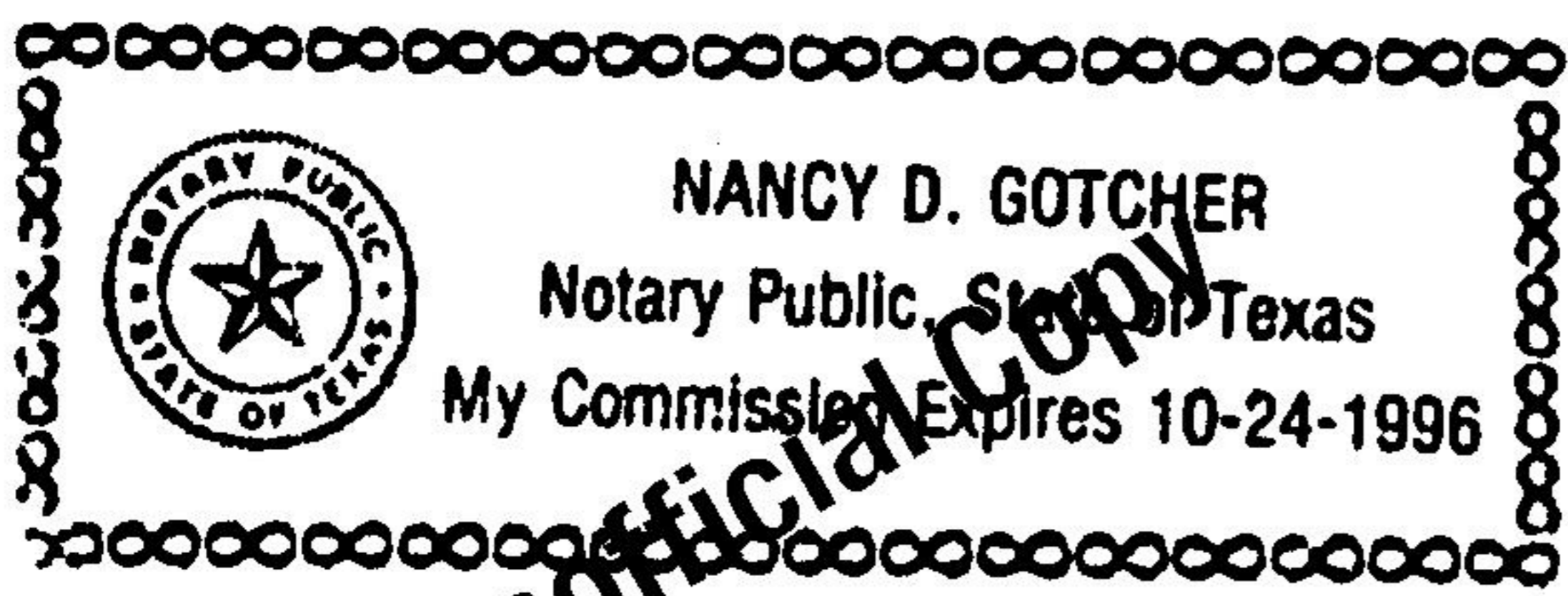

Nancy D. Gotcher
Notary Public, State of Texas

Midland County Clerk Unofficial Copy

Midland County Clerk Unofficial Copy

Midland County Clerk

Midland County Clerk Unofficial Copy

Midland County Clerk Unofficial Copy

Midland County Clerk

Midland County Clerk Unofficial Copy

Midland County Clerk Unofficial Copy

Midland County Clerk

Midland County Clerk Unofficial Copy

Midland County Clerk Unofficial Copy

Midland County Clerk

Midland County Clerk Unofficial Copy

Midland County Clerk Unofficial Copy

Midland County Clerk

Midland County Clerk Unofficial Copy

Midland County Clerk Unofficial Copy

Midland County Clerk

Midland County Clerk Unofficial Copy

Midland County Clerk Unofficial Copy

Midland County Clerk

Midland County Clerk Unofficial Copy

Midland County Clerk Unofficial Copy

Midland County Clerk

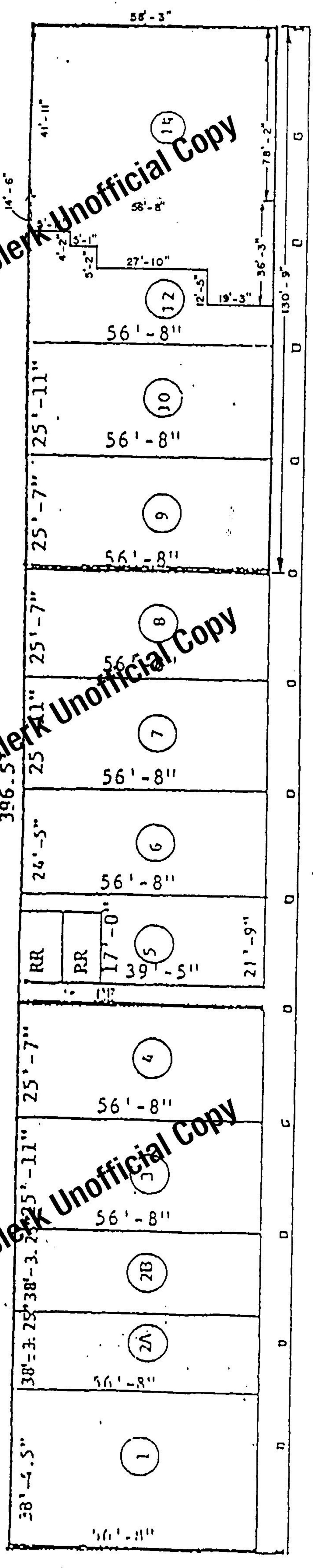

EXHIBIT "B"

Midland County Clerk Unofficial Copy

Midland County Clerk Unofficial Copy

Midland County Clerk

MIDLAND MANOR CONDOMINIUM
SHOPPING CENTER
"EXHIBIT C"

Total Square Footage to be occupied
19798.46 Sq Ft = 100%

Midland County Clerk Unofficial Copy

Midland County Clerk Unofficial Copy

Midland County Clerk

Unit No.	Unit Area Sq Ft	% of Ownership
1	2174.00	10.973
2 A	1092.01	5.510
2 B	1092.01	5.510
3	1468.62	7.411
4	1449.73	7.315
5	942.58	4.756
6	1383.60	6.981
7	1468.62	7.411
8	1449.73	7.315
9	1449.73	7.315
10	1468.62	7.411
12	491.00	2.481
14	<u>3886.37</u>	<u>19.611</u>
	19817.79	100.00%

Midland County Clerk Unofficial Copy

Midland County Clerk Unofficial Copy

Midland County Clerk

Exhibits A, B, and C being revised to reflect an additional interior wall eliminated.

EXHIBIT "C"

Midland County Clerk Unofficial Copy

Midland County Clerk Unofficial Copy

Midland County Clerk

Filed for Record on the 30 day of October A.D. 1992 at 8:00 o'clock A.M.
Duly Recorded this the 30 day of October A.D. 1992 at 8:05 o'clock A.M.

INSTRUMENT NO. 19403

ROSENELLE CHERRY, COUNTY CLERK
MIDLAND COUNTY, TEXAS
By Abby Tedrick, Deputy

Midland County Clerk Unofficial Copy

Midland County Clerk Unofficial Copy

Midland County Clerk