

**ELEVENTH AMENDMENT TO SECOND AMENDED AND RESTATED CONDOMINIUM
DECLARATION FOR RESIDENCES AT THE STONELEIGH, A CONDOMINIUM**

THIS ELEVENTH AMENDMENT TO SECOND AMENDED AND RESTATED CONDOMINIUM DECLARATION FOR RESIDENCES AT THE STONELEIGH, A CONDOMINIUM (this "Amendment") is made by Maple Wolf Stoneleigh, LLC, a Delaware limited liability company ("Declarant").

RECITALS:

A. Declarant is the "Declarant" pursuant to that certain Second Amended and Restated Condominium Declaration for Residences at the Stoneleigh, a Condominium, dated November 14, 2011, and recorded as Document No. 201100328231 of the Real Property Records of Dallas County, Texas as amended by that certain First Amendment to Second Amended and Restated Condominium Declaration for Residences at the Stoneleigh, a Condominium, recorded on March 13, 2013, as Document No. 201300076928 of the Real Property Records of Dallas County, Texas, that certain Second Amendment to Second Amended and Restated Condominium Declaration for Residences at the Stoneleigh, a Condominium, recorded on May 23, 2013, as Document No. 201300161152 of the Real Property Records of Dallas County, Texas, that certain Third Amendment to Second Amended and Restated Condominium Declaration for Residences at the Stoneleigh, a Condominium, recorded on March 26, 2014, as Document No. 201400072707 of the Real Property Records of Dallas County, Texas, that certain Fourth Amendment to Second Amended and Restated Condominium Declaration for Residences at the Stoneleigh, a Condominium, recorded on August 4, 2014, as Document No. 201400196639 of the Real Property Records of Dallas County, Texas, that certain Fifth Amendment to Second Amended and Restated Condominium Declaration for Residences at the Stoneleigh, a Condominium, recorded on February 5, 2015, as Document No. 201500029947 of the Real Property Records of Dallas County, Texas, that certain Sixth Amendment to Second Amended and Restated Condominium Declaration for Residences at the Stoneleigh, a Condominium, recorded on February 25, 2015, as Document No. 201500045463 of the Real Property Records of Dallas County, Texas, that certain Seventh Amendment to Second Amended and Restated Condominium Declaration for Residences at the Stoneleigh, a Condominium, recorded on April 30, 2015, as Document No. 201500109974 of the Real Property Records of Dallas County, Texas, that certain Eighth Amendment to Second Amended and Restated Condominium Declaration for Residences at the Stoneleigh, a Condominium, recorded on July 13, 2015, as Document No. 201500162327 of the Real Property Records of Dallas County, Texas, that certain Ninth Amendment to Second Amended and Restated Condominium Declaration for Residences at the Stoneleigh, a Condominium, recorded on September 24, 2015, as Document No. 201500256934 of the Real Property Records of Dallas County, Texas, that certain Tenth Amendment to Second Amended and Restated Condominium Declaration for Residences at the Stoneleigh, a Condominium, recorded on February 2, 2016, as Document No. 201600028001 of the Real Property Records of Dallas County, Texas, and that certain Corrective Amendment to Tenth Amendment to Second Amended and Restated Condominium Declaration for Residences at the Stoneleigh, a Condominium, recorded on March 29, 2016, as Document No. 201600081055 of the Real Property Records of Dallas County, Texas (as amended, the "Declaration"), covering the property described therein.

B. Declarant now desires to exercise its rights under the Declaration to amend the Map and Exhibit "C", to (i) adjust the boundary between the "C" and "D" Units on Levels 6, 7, 8, 9, 11 and 12M and (ii) update the Allocated Interests, as described in this Amendment.

NOW THEREFORE, for and in consideration of the premises and for other good and valuable consideration, the receipt and sufficiency of which is hereby acknowledged, the Declaration is hereby

amended as follows:

1. The Map attached as Exhibit "B" to the Declaration is hereby amended and restated to replace sheets 22, 23, 24, 25, 27 and 29 in their entirety with the sheets attached hereto as Schedule 1.
2. Exhibit "C" to the Declaration is hereby amended and restated in its entirety, as set forth in Schedule 2 attached hereto.
3. Except as expressly modified herein, the Declaration remains unmodified and in full force and effect. All terms used herein with initial capital letters and not otherwise defined shall have the meanings specified in the Declaration.

[Signature Pages Follow]

Unofficial Copy

IN WITNESS WHEREOF, the Declarant has caused this Amendment to be executed on October 25, 2016.

DECLARANT:

MAPLE WOLF STONELEIGH, LLC,
a Delaware limited liability company

By: Maple Wolf Manager, LLC,
its sole manager

By: [Signature]
Mehrdad Moayed, President

STATE OF TEXAS §
 §
COUNTY OF DALLAS §

This instrument was acknowledged before me on the 25th day of October, 2016, by Mehرداد Moayed, the President of Maple Wolf Manager, LLC, the sole manager of Maple Wolf Stoneleigh, LLC, a Delaware limited liability company, on behalf of said limited liability companies.

My Commission Expires:

April 13, 2017

[Signature]
Notary Public - State of Texas
Veronica Parra
Printed Name of Notary

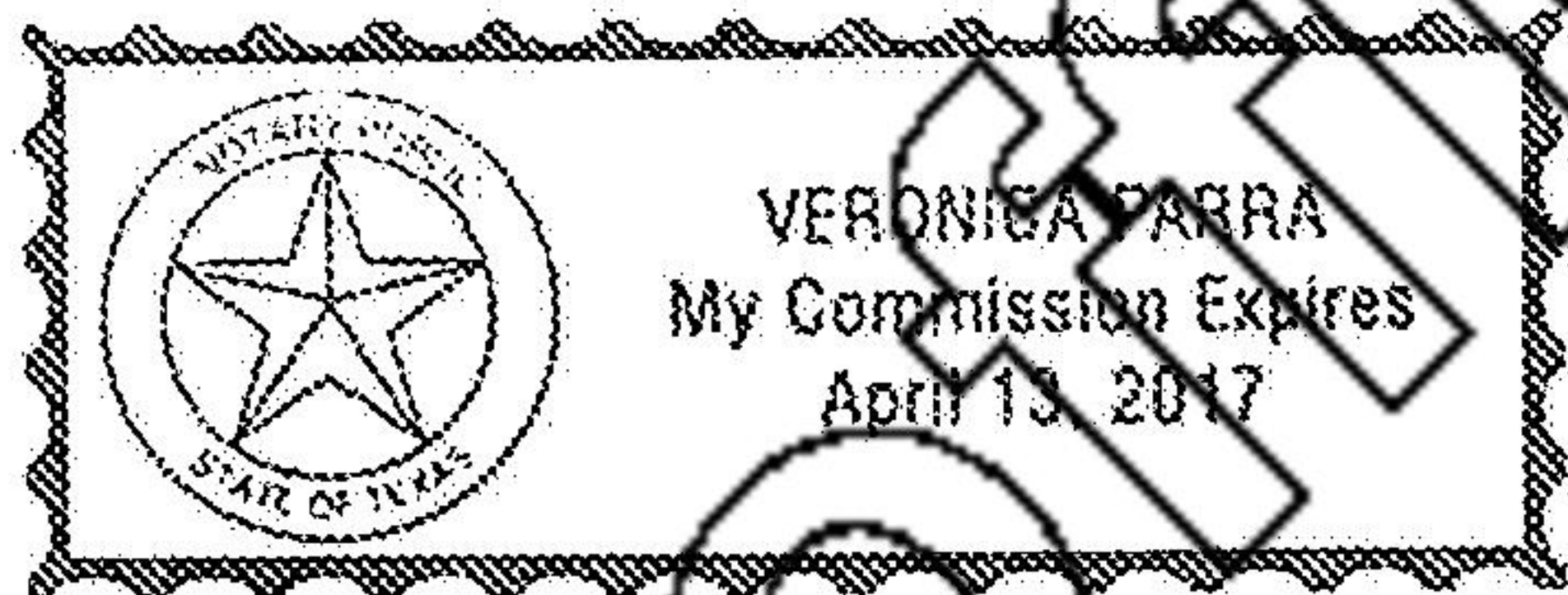

Unofficial Copy

Schedule 1

Revised Sheets 22, 23, 24, 25, 27 and 29 of the Map

[see attached]

Unofficial Copy

Residences at the Stoneleigh, a Condominium Map Exhibit "B" Level 6



SCALE: 1" = 30'

LEGEND

- GCE—General Common Element (GCE)
- LCE—Limited Common Element (LCE)
- Unit

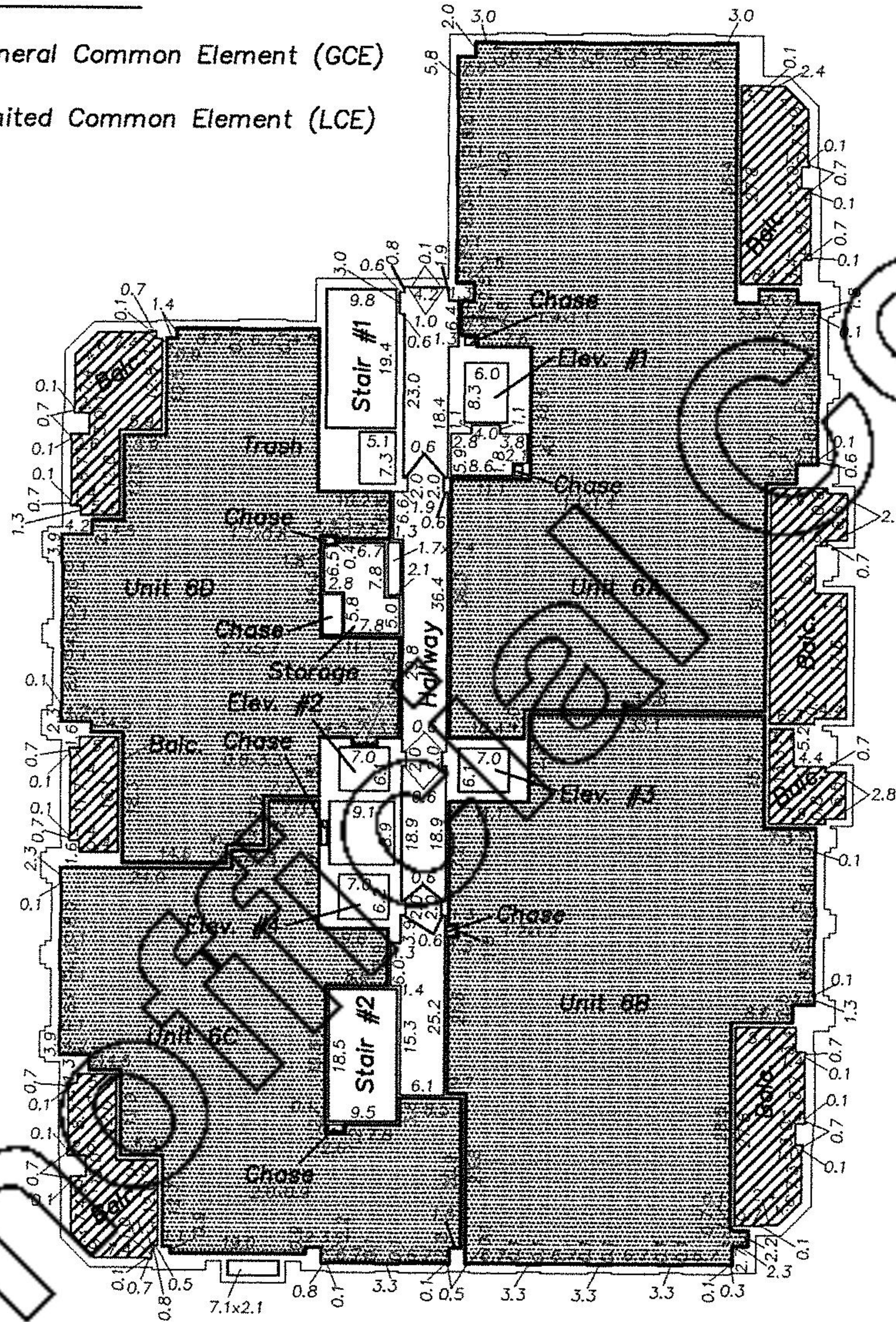

Elevations on this level are from 168.46' to 180.00', based on a Finished Floor Elevation of 100.00'; at Level 1 of the Condominium.

ARS

Engineers, Inc.

12801 N. Central Expressway Suite 1250
Dallas, Texas 75243
(214) 739-3162 Fax (214) 739-3169